

FACSIMILE

SAGEM FAX 305

User manual

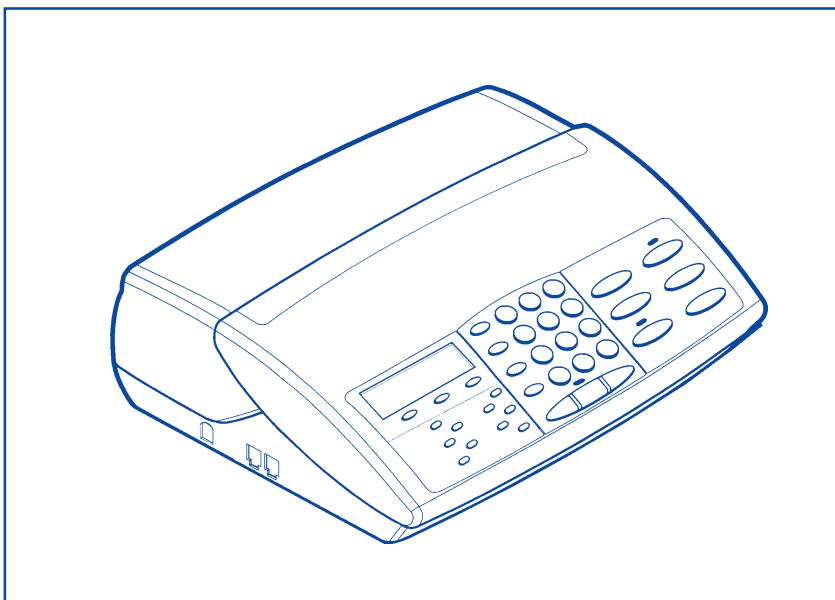

GENERAL VIEW

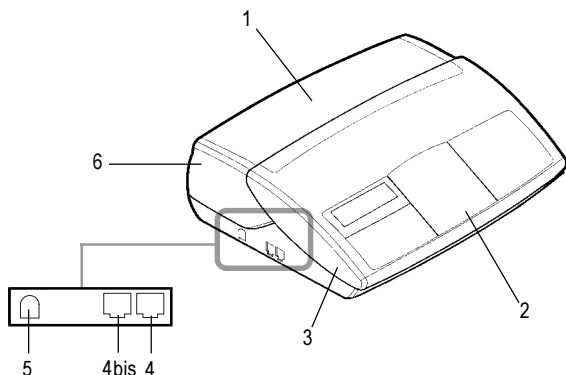

PANEL

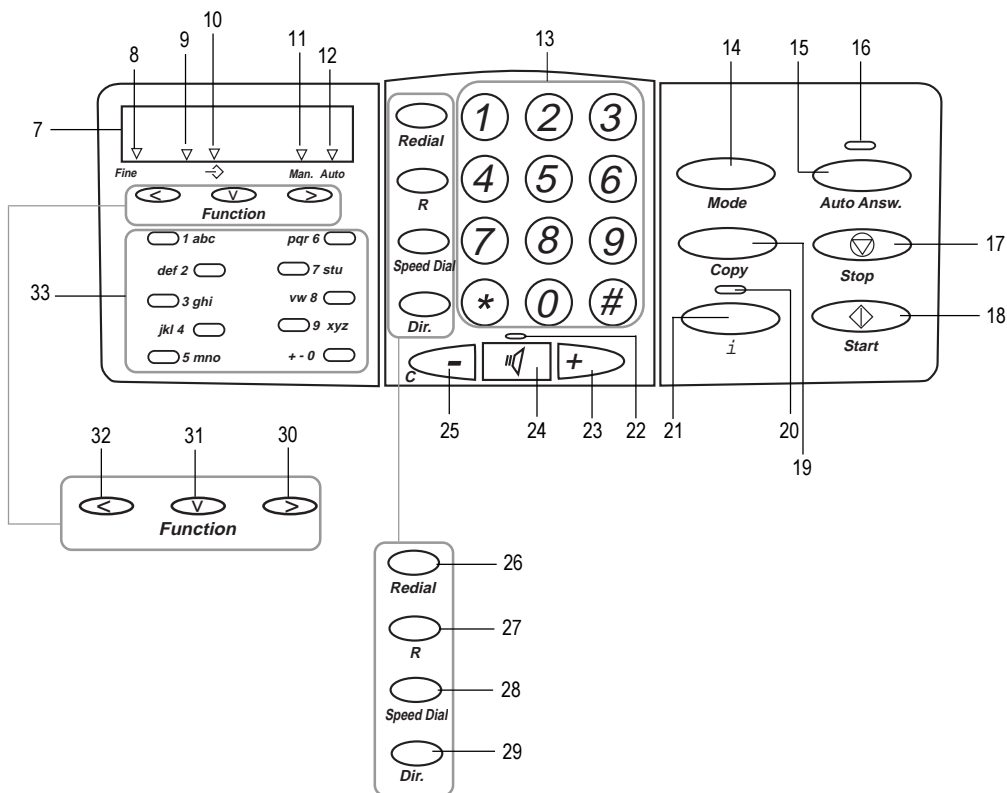

- 1 Fax access panel.
- 2 Key board
- 3 Front cover.
- 4 Line socket.
- 4 bis Socket for a telephone answering machine or a personal handset.
- 5 Mains socket.
- 6 Rear cover.
- 7 LCD display panel (16 characters and 5 icons).
- 8 Fine icon: FINE resolution mode (high quality).
- 9 Error icon: appears in the event of an incident (e.g. open cover).
- 10 On-line icon:
Switched on: transmitting
Blinking: estats listing of connection
- 11 Man icon:
Switched on: telephone operation
Blinking: telephone's ringing remove
- 12 Auto icon:
Switched on: automatic fax reception
- 13 Numeric keyboard.
- 14 Mode key: choice of analysis mode
- 15 Auto Answ. key: automatic reception
- 16 Auto Answ. light:
Switched on: automatic reception
Switched off: manual reception
- 17 Stop key: stop the operation in process
- 18 Start key: transmission of fax.
- 19 Copy key: photocopy.
- 20 i light: function list printing.
- 21 i key: function list printing.
- 22 Loudspeaker light: connection without unhooking or amplified listened.
- 23 Key for increasing the loudspeaker's sound level.
- 24 Loudspeaker key: amplified listening
- 25 Key for reducing the loudspeaker's sound level.
- 26 Redial key: automatic recall of last number dialled.
- 27 Recall key: to insert a pause in the number being dialled or as a "FLASH" key (PABX).
- 28 Speed Dial key: dials or records a shortened number from the directory.
- 29 Dir. key: directory printing.
- 30 Goes direct to the following option on the menu displayed.
- 31 Function key: to access the unit's various functions and as a confirmation key.
- 32 Return to previous option in the displayed menu or shifting of cursor to the left.
- 33 Keyboard of one touch keys for calling or entering of alphanumeric characters.

CONTENTS

CHAPTER 1 : INSTALLATION

1. UNPACKING THE UNIT -----	4
2. INSTALLATION -----	4
4. CONNECTIONS -----	6
3. OUTPUT PAPER -----	6
5. SETTING UP THE UNIT -----	7

CHAPTER 2 : FACSIMILE

1. INSERTING A DOCUMENT -----	10
2. TRANSMITTING DOCUMENTS -----	10
3. RECEIVING FAXES -----	12
4. QUEUE FUNCTION -----	13
5. FAX-BACK AND POLLING -----	13

CHAPTER 3 : PERSONAL TELEPHONE SET AND TAM

1. CONNECTION -----	14
2. SETTING UP -----	14
3. OPERATION -----	14

CHAPTER 4 : OTHER FUNCTIONS

1. PHOTOCOPYING -----	15
2. PRINTING OUT -----	15
3. REMOTE OPERATION FROM ANOTHER HANDSET ON THE SAME LINE -----	15
4. INK GAUGE -----	15

CHAPTER 5 : APPENDICES

1. SETTINGS -----	16
2. TRANSMISSION REPORT CODES -----	16
3. TROUBLESHOOTING -----	17

CHAPTER 1: INSTALLATION

1. UNPACKING THE UNIT

Check the presence of the following items:

- Machine
- Ink ribbon
- Ribbon gauge support card
- Mains supply unit
- Telephone cable
- Paper
- User manual

2. INSTALLATION

INK RIBBON

The ink ribbon enables the unit to print on normal paper.
The gauge enables screen display, after printout, of remaining ink ribbon.



Only use an ink ribbon that matches the manufacturer's specifications. The use of other types of ink ribbons could result in damage to the main unit and invalidate the warranty. Documents printed by your unit may be read from the used portion of the ink ribbon. If these documents are confidential, you may want to remove the ink ribbon whenever you leave the unit.

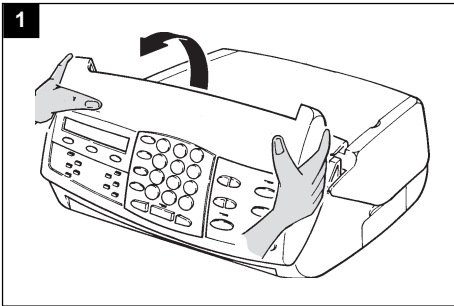

Open the front cover : let it swivel round to you until it remains open.

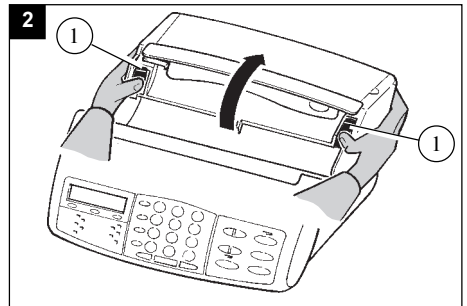

Open the back cover : unlock the latches (1) before swiveling the cover round to the back.

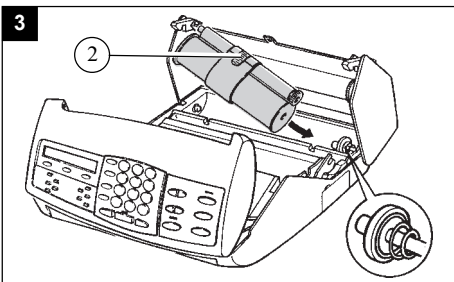

Position the ink ribbon over its housing under the rear cover.
Insert the ink ribbon into its housing without removing the adhesive strip (2):

- position the right end of the main roller onto the retractable axle.
- position the left end of the main roller onto the left axle.

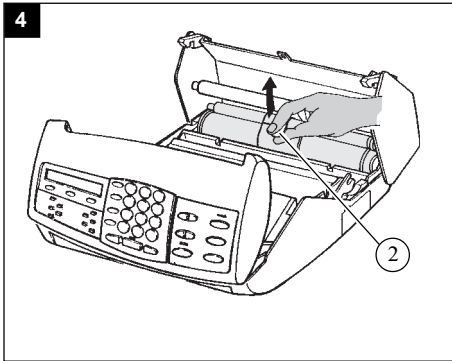

Pull off the adhesive strip (2) from the ink ribbon.

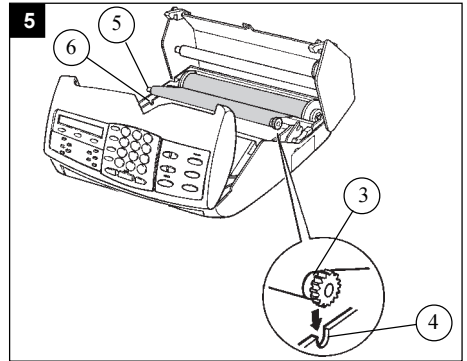

Insert the small roller in its housing: check that the gear axle (3) is correctly positioned in its housing (4), and that the other axle (5) is also correctly positioned (6) in its housing.

INK RIBBON GAUGE

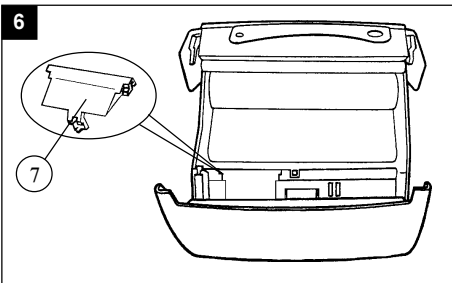

Remove the gauge housing flap (7):

- slip the flap backward, then
- lift the front part of the flap to remove it from the main unit.

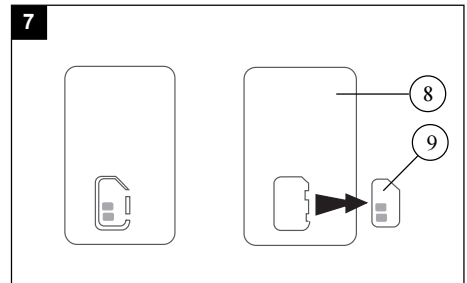

Remove the (pre-cut) gauge (9) from the ribbon gauge card (8).

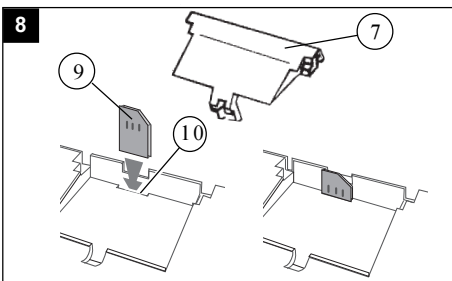

Insert the gauge (9) into the slit (10) of the gauge housing, ensuring that the chip faces you and the bevelled corner is positioned top right. Replace the flap (7).

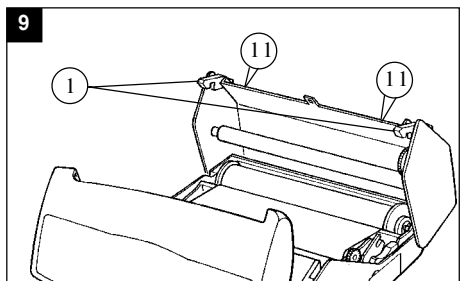

Close the rear cover: press down simultaneously on both sides of the cover (11) until the two latches (1) click into place.



If the gauge is not installed or not properly installed, the unit displays:

MISSING GAUGE

3. LOADING PAPER



You may use any standard plain paper (A4 format photocopying paper, approx. 80 g/m²). However, for optimal print quality results, we suggest you use the type of paper recommended by the manufacturer.

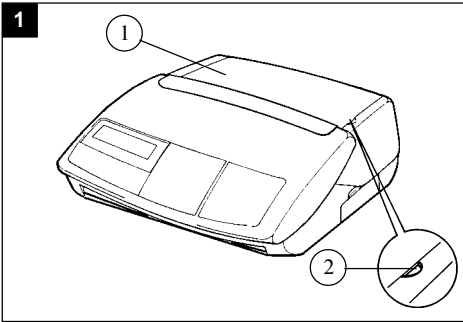

To open the fax access door (1), you must lift it by the side (2).

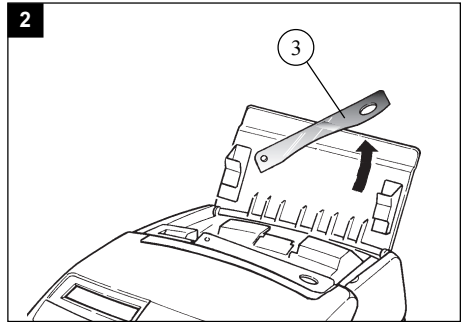

Push the paper supporting bracket up (3).

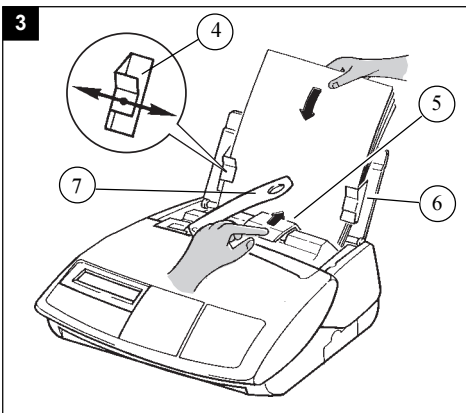

Prepare a sheaf of normal paper (30 sheets max.).

Insert the paper between the paper guides (4 and 6).

Adjust the left paper guide (4) to the width of the paper.

Push down the clamp (5) to insert the paper in the paper housing of the machine.



Push up the supporting bracket (6) which will ease the piling up of printed pages.

4. CONNECTIONS

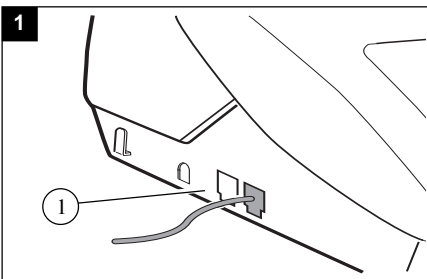

Connect the small plug of the telephone cable into the appropriate connector (1) on the main unit, and connect the other end to your wall telephone socket.

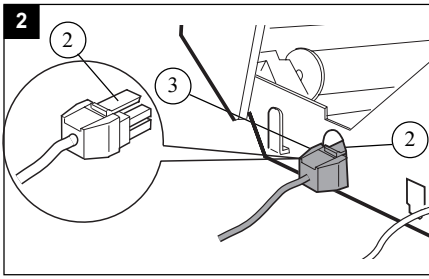

Connect the small plug of the mains supply unit into connector (3) on the main unit. Ensure the strip (2) is facing **upwards**.

Check if the wall socket to which you'll connect your machine complies with directives on the label under the mains supply unit.

Connect the mains cable plug of the mains supply unit to the wall socket.

5. SETTING UP THE UNIT

When the unit is powered up for the first time, you will be prompted to set the date and time. Having entered the date and time, you may use all your unit's basic functions. However, we recommend that you finish programming your unit (see the section entitled **Programming**).



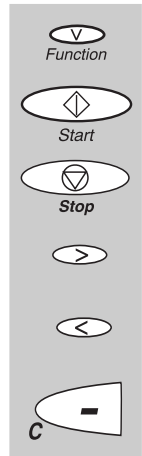

PROGRAMMING

The following keys are used to program your unit:

- **FUNCTION:** or **V** key Enables you to enter FUNCTION mode or to confirm an entry or option.
- **START** key Used to confirm an entry or option.
- **STOP** key Enables you to exit the FUNCTION mode. Any changes which were not confirmed will be discarded.
- **>** key Enables you to move to the next option or to shift the cursor right in an input field.
- **<** key Enables you to return to the previous option or to shift the cursor left in an input field.
- **C** key Enables you to exit a function or go back up one level in the menu structure.



There are 2 ways to program your unit:

- by invoking the appropriate function directly, e.g.    
- (to print out the listing of function codes press FUNCTION, 5, 1, START)
- by scrolling through the unit's menus using the V, > and <.. keys, e.g.



ENTERING OR CHANGING THE DATE AND TIME

- Press FUNCTION, 2, 1 and START
- Enter the date and time using the numerical keypad, then Press START to confirm. For example, to enter **7 May 1999, 9:15**, enter **0 7 0 5 9 9 0 9 1 5** then Press START.

STORING YOUR CSID

This is the number of the telephone line to which your unit is connected. This number will be printed on the header of the faxes you send.

■ Press FUNCTION, 2, 2 and START

■ Enter your CSID using the numerical keypad, then Press START to confirm.

Notes: to erase the last character entered, press the < key.

You can insert spaces to make the number more legible, using the > key.

To insert a “+” sign, press the “*” key.

ENTERING YOUR NAME

This name will be printed on the header of the faxes you send.

You can enter any letter in the alphabet using the alphanumeric keys “abc”, etc.

Press several times on the appropriate alphanumeric key to obtain the letter you require (e.g. for the def key, pressing the key repeatedly will scroll through characters D, E, F, 2, D, E, etc.). As soon as the appropriate character is displayed, you may proceed to select the next character by pressing another alphanumeric key or by pressing >.

■ Press FUNCTION, 2, 3 and START.

■ Enter your name using the alphanumeric keys, then Press START to confirm.

Notes: to erase the last character entered, press the < key .

You can insert spaces by pressing the > key.

To insert a “+” or “-“ sign, press the “0” key.

TYPE OF NETWORK

Customise your unit to the particular type of network it is linked up to

- If you are linked directly to the public network (e.g. in a private home), you need not make any modifications since the unit is set to “public network” by default on leaving the factory.

- If you are not linked up to the public network (e.g. in a large company), you should set the unit to “private network”.

Proceed as follows:

■ Press FUNCTION, 2, 4 and START.

Scroll through the options by pressing the > key, and press START to confirm your choice.

SETTING THE NUMBER OF RINGS BEFORE AUTOMATIC ANSWER

■ Press FUNCTION, 2, 6 and START.

■ Enter the new number of rings required and Press START to confirm.

PULSE / TONE DIALLING

Your unit has been factory-programmed to operate on digital exchanges that support tone dialling.

If you are unable to connect and make a call, this may be because you are connected to an exchange that only supports pulse dialling.

■ Press FUNCTION, 2, 5 and START.

The current dialling mode is displayed: TONE or PULSE

■ Press the > key to select the other mode and Press START to confirm.

SELECTING THE RINGING TONE

■ Press FUNCTION, 2, 7 and START. You will hear the current ringing tone. Use the > key to select another tone.

■ To set the volume of the ringing tone, press the + and - keys (4 possible levels).

■ When you have set the appropriate ringing tone and volume, press START to confirm your entries.

Note: Select WITHOUT RING to eliminate the ringing tone outright ; the MAN icon will flash instead.

RECORDING OF CORRESPONDENT IN THE DIRECTORY

You may store up to 40 numbers (either phone or fax) which can then be speed dialled simply by entering their 2-digit reference code (00 to 39).

- Press FUNCTION, then SPEED DIAL.
- Enter the 2-digit number of the desired memory location, then Press START to confirm.
- Enter your contact's name or a handle using the alphanumeric keypad. To enter "LONDON" for instance, perform the following sequence:

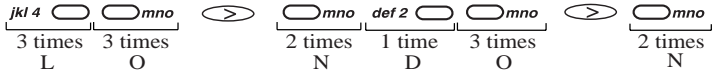

- Press START to confirm your entry.
 - Now enter your contact's number using the keypad, and press START to confirm.
- Note:** if you want to insert a dialling pause (e.g. to exit a private corporate PABX), press the RECALL key on the alphanumeric keypad. A "/" character will be inserted in the number displayed.

MODIFYING/DELETING A STORED NUMBER

To modify or delete an entry in your directory, follow the same procedure as for entering a new entry:

- Press FUNCTION, then SPEED DIAL.
- Enter the 2-digit number of the desired memory location, then press START to confirm.
- Erase your contact's name using the < key.
- Erase your contact's number using the < key.

CALLING A NUMBER STORED IN THE DIRECTORY

There are several ways to call a number stored in the directory:

- Press SPEED DIAL, 2, 0 (to call the number stored in memory location 20) and lift the handset to speak.
- Press one of the one-touch dialling keys located to the bottom left of the keypad and numbered 1 to 0. The 0 key corresponds to SPEED DIAL 00, the 1 key to SPEED DIAL 01... the 9 key to SPEED DIAL 09.
- Press SPEED DIAL, then > or < in order to scroll through the numbers in alphabetical order; lift your handset when the number you wish to dial is displayed on screen.
- Press SPEED DIAL, SPEED DIAL and then > or < to scroll through the contacts in numerical order and lift your handset when the name of the contact you wish to call is displayed on screen.

CHAPTER 2 : FACSIMILE

DO NOT INSERT IN THE UNIT DOCUMENTS WITH:

- paper clips, staples, or other similar objects,
- pins or glued-on inserts,
- sellotape,
- liquid correction fluid,
- wet ink.

Do not insert documents that are glued together.

USE DOCUMENTS OF THE FOLLOWING SPECIFICATIONS ONLY:

- A4 format (21 x 29.7 cm),
- average thickness (such as photocopying paper),
- non-transparent,
- non-torn, crumpled or curled.

1. INSERTING A DOCUMENT

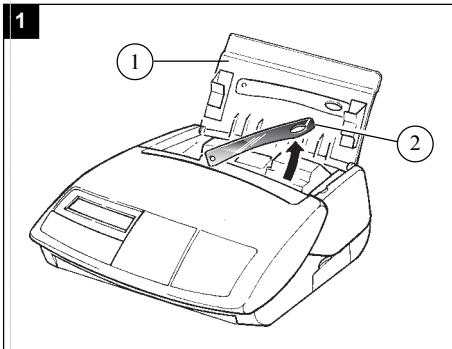

Open the fax access panel (1).
Lift the document support guide (2).

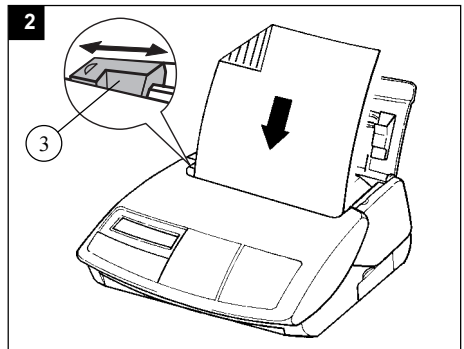

Insert the document (15 pages maximum) face down into the document feeder. Adjust the sliding document guide (3) to the width of the document if necessary. The unit's display reads "READY".

Note: your unit is equipped with an automatic sheet feeder. The bottom sheet will be sent out first.

2. TRANSMITTING DOCUMENTS

IMMEDIATE TRANSMISSION

- Insert the document into the document feeder.
- Dial your contact's fax number.
- Press START, your unit will send out the document.

Note 1: when dialling the number, you can erase the last character entered by using the < key.

Note 2: should transmission fail (e.g. the number is engaged), the unit will try again after waiting for a few minutes. You may short-cut the waiting time by pressing START.

TRANSMISSION WITH CALL MONITORING

- Insert the document into the document feeder.
- Press the LOUDSPEAKER key; you will then hear the dial tone.
- Dial your contact's number (you will hear the unit go through the motions).
- Press START as soon as you hear the fax tone from the remote terminal.

SCHEDULED TRANSMISSION

The scheduled transmission facility enables you to specify the time when you want the unit to send out a fax.

- Insert the document, press FUNCTION, 3, 1 and START.
- Enter your contact's fax number (you may use a speed dialling code or a one-touch dialling key).
- You may either send your document right away by pressing START or scroll down the menu by pressing FUNCTION. If you chose to scroll down the menu, the unit will display the following message:

SET HOUR	
16-24	<u>1</u> 6-24
16-24	20-3 <u>0</u>

- Enter the time when the fax is to be sent, e.g. 20:30.
- Press START or scroll down the menu by pressing FUNCTION.
- If you chose to scroll down the menu, the screen will display the following message:
PAGES NB
- Enter the number of pages to be transmitted and press START.
The pending document is signalled by a flashing display.

Note 1: to cancel a scheduled transmission: if the document is in the document feeder, simply remove it.

Note 2: to send the document right away: if the document is in the document feeder, simply press START.

SENDING TO A RECIPIENT IN THE DIRECTORY

- Insert the document to be sent, and, for example:
 - Press SPEED DIAL, 2, 0 and START to call the recipient whose number is stored under memory location 20.
- or
- Press a one-touch dialling key (e.g.  3 ghi) to call the recipient whose number is stored in memory location 03.
- or
- Press SPEED DIAL, and use the < and > keys to scroll through the numbers stored in alphabetical order. When the desired recipient's number is displayed on the unit, press START.
- or
- Press SPEED DIAL, then SPEED DIAL again and use the < and > keys to scroll through the numbers stored in numerical order. When the desired recipient's number is displayed on the unit, press START.

SETTING THE RESOLUTION OR SCAN MODE

Press the MODE key to toggle the resolution setting:

- Use **normal** mode for good quality documents which do not include minute detailing.
- Use **fine** mode (the FINE icon comes on) for documents which include small characters or drawings.

TRANSMISSION REPORTS

Choose between 3 options:

- Press FUNCTION, 3, 4 and START.
- Press > to choose another option:

WITHOUT: The documents you send will not generate a report.

WITH: A transmission report is printed upon proper completion or failure of the transmission.

IF ERROR: A transmission report is printed out only upon failure of the transmission.

- Press START to confirm your choice.
If you want to print out a report for the previous transmission at any time:
- Press FUNCTION, 5, 5 and START.

3. RECEIVING FAXES

- Put paper in the machine (see the paragraph 1 "LOADING PAPER")
Note: the insertion of paper is obligatory to receive faxes.

AUTO ANSWER

In the AUTOMATIC ANSWERING mode (AUTO icon switched on), the machine can receive faxes automatically, even when you are away.

MANUAL RECEPTION

If after having lifted your telephone handset (on a telephone set connected to the piggy-back connector of the line cord), you hear a fax tone, the machine prints automatically the fax received and then you can hang up.

If you do not hear your correspondent after having picked up the handset, press START and hang up. In this case don't forget to remove any document which might be inserted in the document feeder, or it will be sent.

SELECTED RECEPTION MODE

- Press the AUTO ANSW. key once or many times to select the desired reception mode.

Note: if you choose AUTO mode, you can set the number of rings before the machine answers.

4. QUEUE FUNCTION

This function enables you to manage pending operations (scheduled transmission, deposit, polling).

PRINTING OUT THE LIST OF PENDING OPERATIONS

This report lists the characteristics of each pending operation.

- Press FUNCTION, 6, 5 and START.

DELETING PENDING OPERATIONS

To delete a pending operation, proceed as follows:

- Press FUNCTION, 6, 3 and START.

You can scroll through all currently pending operations by pressing the > key or entering the number of the selected operation.

The different types of pending operations are:

- TX: Send.
- DOC: Deposit.
- POL: Polling.

- Press START to select the operation to be deleted. You will be prompted for confirmation:
- Press START to confirm deletion.

IMMEDIATE EXECUTION OF A PENDING OPERATION

To immediately execute a pending operation:

- Press FUNCTION, 6, 1 and START.

Position yourself on the requisite pending operation using the > key and press START to confirm.

MODIFYING AN OPERATION

To modify a pending operation:

- Press FUNCTION, 6, 2 and START.

Position yourself on the desired pending operation using the > key and press START to confirm.

You may then change the recipient's number or the scheduled transmission time.

- Press START to confirm.

5. FAX-BACK AND POLLING

DEPOSITING A FAX-BACK DOCUMENT

To set up a document in your unit for polling by another fax machine (the transmission of the document being initiated remotely by the recipient):

- Check that your unit is in automatic receive mode (the AUTO icon should be switched on).
- Insert a document into the document feeder.
- Press FUNCTION, 3, 3 and START.
- Press START to confirm.

POLLING

To poll a document from a remote fax terminal:

- Press FUNCTION, 3, 2 and START.
- Enter the fax number of the remote terminal from which you want to poll the document (you may use the directory);
- For immediate polling, press START; alternatively, you can specify a scheduled polling time by pressing FUNCTION.
- Enter the polling time.
- Press START to confirm. The screen displays the time when the polling operation is to be carried out.

CHAPTER 3 : PERSONAL TELEPHONE SET AND TELEPHONE ANSWERING MACHINE

You can connect a telephone set and/or a telephone answering machine on your machine: thus, on the same telephone line, you get:

- a fax,
- a telephone,
- a personal telephone answering machine.

1. CONNECTION

- Connect the line cord of your personal telephone answering machine (TAM) and/or your telephone handset to the connector (1) located on the left side of the facsimile machine line.

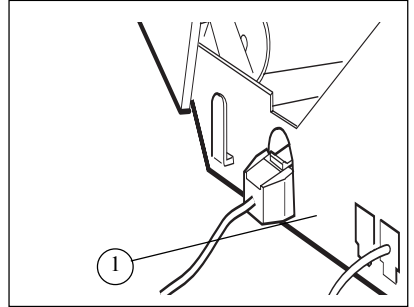

2. SETTING UP

- Make sur your personal telephone answering machine is permanently ready to operate (i.e. that it is powered an in automatic mode).
- Make sur your personal telephone answering machine is programmed to answer after a low number of rings (fewer than the number of rings for your fax machine). This will ensure that installation will operate correctly an conveniently for your callers.

3. OPERATION

MANUAL RECEPTION MODE

Your machine does not answer automatically.

If you lift your personal handset, you can talk with your correspondent (if it is a fax machine calling, your machine will print the fax automatically).

AUTOMATIC ANSWERING MODE

When the call is a fax call, the machine answers automatically and prints the fax message automatically.

If you lift your personal handset quickly, you will be able to talk to your party (if the call is a fax call, the machine will print the fax received automatically).

If your personal telephone answering machine is ready to operate, it answers automatically and records automatically the telephone call (if the call is a fax call, the machine will print the fax received automatically).

CHAPTER 4: OTHER FUNCTIONS

1. PHOTOCOPYING

Your unit can be used for photocopying.

- Insert paper into the printer sheet feeder.
- Insert the document to be photocopied into the document feeder as if to send it out.
- Press COPY key.

The document will be photocopied in “fine” mode.

2. PRINTING OUT

FUNCTION GUIDE

This guide lists the functions supported by your unit, together with their numerical access codes.

- Insert paper into the feeder and press **1** key.

LOGS

You can print out a log showing details of the last 30 faxes sent and received.

- Press FUNCTION, 5, 2 and START.

DIRECTORY

- Press FUNCTION, 5, 3 and START.

SETTINGS

The list of settings reflects the unit's operating mode at any point in time.

- Press FUNCTION, 5, 4 and START.

3. REMOTE OPERATION FROM ANOTHER HANDSET ON THE SAME LINE

One remote command is available from a telephone (with touch tone dialling) connected in parallel to the machine.

Note: if the parallel telephone is configured for pulse dialling, you must press * key to switch to tone dialling

REMOTE FAX RECEIVE INSTRUCTION

If you have lifted the receiver to answer an incoming call from another phone terminal, you can remotely instruct your terminal to switch into fax receive mode and pick up an incoming fax by dialling **(#) (7)** on your telephone's keypad .

4. INK GAUGE

The ink gauge enables the unit to display the percentage of remaining ink ribbon:

- Press FUNCTION, 5, 6 and START.

CHAPTER 5 : APPENDICES

1. SETTINGS

To view the unit's settings, press FUNCTION, 9 and START.

The user can scroll through the settings by using the > and < navigation keys.

- PRINT LIST:** Printing to the list of parameter settings
- TX HEADER:** Transmit your name, fax number, the date and time to the recipient; the data will be displayed in the header of the faxes they receive.
- TX LOCK UP:** Set a ceiling transmission speed for faxes sent to selected numbers in the directory
- ANTI ECHO:** This setting blocks the satellite echo in the event of quality problems with long-distance faxing.
- RX HEADER:** Print out the name and fax number of the sender as well as the current date and time on the headers of incoming faxes.
- RX LOCK UP:** Ceiling receive speed for incoming faxes
- NB OF PAGES:** This parameter shows the number of pages printed out (incoming faxes and local copies) since the unit was plugged in.
- RECALL LENGTH:** Duration of the line break induced by the "Pause" signal emitted by the R key: long or short.

2. TRANSMISSION REPORT CODES

The log (send/receive) and the transmission report detail the outcome of each transmission. In the event of an incident, they will use one of the following codes:

<i>Code</i>	<i>Meaning and action</i>
1	No answer: try again later.
3	Call interrupted by user pressing STOP
4	Invalid speed dial number: check number.
5	Document feeder problem during the call: paper jam or document feeder malfunction.
7	Bad line or remote terminal malfunction: try again.
8	The document sent may not have been received in full: send again and check with recipient.
A	Polling operation failed: no fax-back document on remote terminal.
B	There is a difference between the number of pages logged for sending and the number of pages actually sent out. Check the number of pages.

3. TROUBLESHOOTING

PROBLEM	SOLUTION
- Blank unit display.	<ul style="list-style-type: none"> • Check that the power cord and the power adapter cord are properly connected.
- The unit does not answer incoming calls after several rings.	<ul style="list-style-type: none"> • The AUTO icon may be off: check the receive mode (Manual/automatic). • Check the number of rings • Configure the unit for “private network” (see the sections headed Setting the number of rings and Type of network in the INSTALLATION chapter).
- Blank photocopies.	<ul style="list-style-type: none"> • The document was positioned facing the wrong way round in the feeder.
- The telephone exchange does not recognise the number dialled.	<ul style="list-style-type: none"> • Check that the telephone cord is properly plugged in. • Configure your unit for pulse dialling (see the section headed Pulse/tone dialling in the INSTALLATION chapter).§
- The terminal does not ring.	<ul style="list-style-type: none"> • The MAN icon is flashing: re-activate the ringing tone (see the section headed Setting the ringing tone in the INSTALLATION chapter).
- The telephone does not work.	<ul style="list-style-type: none"> • The mains may be down. • Check that the telephone line cord is properly connected.
- One or more vertical black lines on documents copied locally or sent.	<ul style="list-style-type: none"> • Open the cover and clean the scanning sub-assembly located opposite the white roller using a soft but not fluffy cloth dipped in surgical spirit. After cleaning, close the front cover and make a local copy to check that the black lines have disappeared.
<p>- The unit displays the following messages:</p> <p style="padding-left: 40px;">PAPER OUT PRINTER COVER PAPER JAM</p> <p style="padding-left: 40px;">OVERHEATING</p> <p style="padding-left: 40px;">GAUGE EMPTY</p> <p style="padding-left: 40px;">MISSING GAUGE</p> <p style="padding-left: 40px;">CHANGE RIBBON REMOVE DOCUMENT</p>	<ul style="list-style-type: none"> • Insert more paper in the paper feeder. • Close the rear cover. • Open the rear cover to access the paper circuit. Check that the rear cover is properly secured after closing it. • The last documents printed out are blackened; the printer’s temperature is too high. Wait a few minutes for it to cool down. • You may have forgotten to replace the gauge smartcard when you put in the ink ribbon. • Open the gauge housing flap and check that the gauge smartcard is inserted and correctly positioned. • No ink ribbon left: install a new ribbon and gauge. • Open the front cover and check the document circuit.
Other	<ul style="list-style-type: none"> • Disconnect your unit from the mains and reconnect it. If the problem persists, contact our maintenance department.

CONSUMABLES

INK RIBBONS

The TTR 815 ink ribbon used in your fax machine provides over 230 pages (*) without user intervention, whatever the contents of the documents printed.

Use the following references to order new ribbons :



TTR 815 INK RIBBON, ref: 23327983-7

PAPER

Print quality will vary according to the kind of paper used.

For best results, use SAGEM's "Série 300" paper, available in reams of 500 sheets.

SAGEM "Série 300" paper, ref: 23273604-9

INK RIBBON + PAPER PACKAGE

To simplify your consumables requirements, a package comprising a TTR 815 ink ribbon and 250 sheets of SAGEM "Série 300" paper is available under the following reference:

TTR package, ref: 23295329-4

* PLEASE NOTE: the free sample ink ribbon provided with your unit will allow you to print about 50 pages.

LU 23227623-3



* 2 3 2 2 7 6 2 3 3 *

DATA SUBJECT TO CHANGE WITHOUT NOTICE

SAGEM SA

6, avenue d'Iéna - 75783 PARIS CEDEX 16 - FRANCE

<http://www.sagem.com>